

Landscape Rakes

LR0548, LR0560,
LR1560, LR1572, LR1584 & LR1596

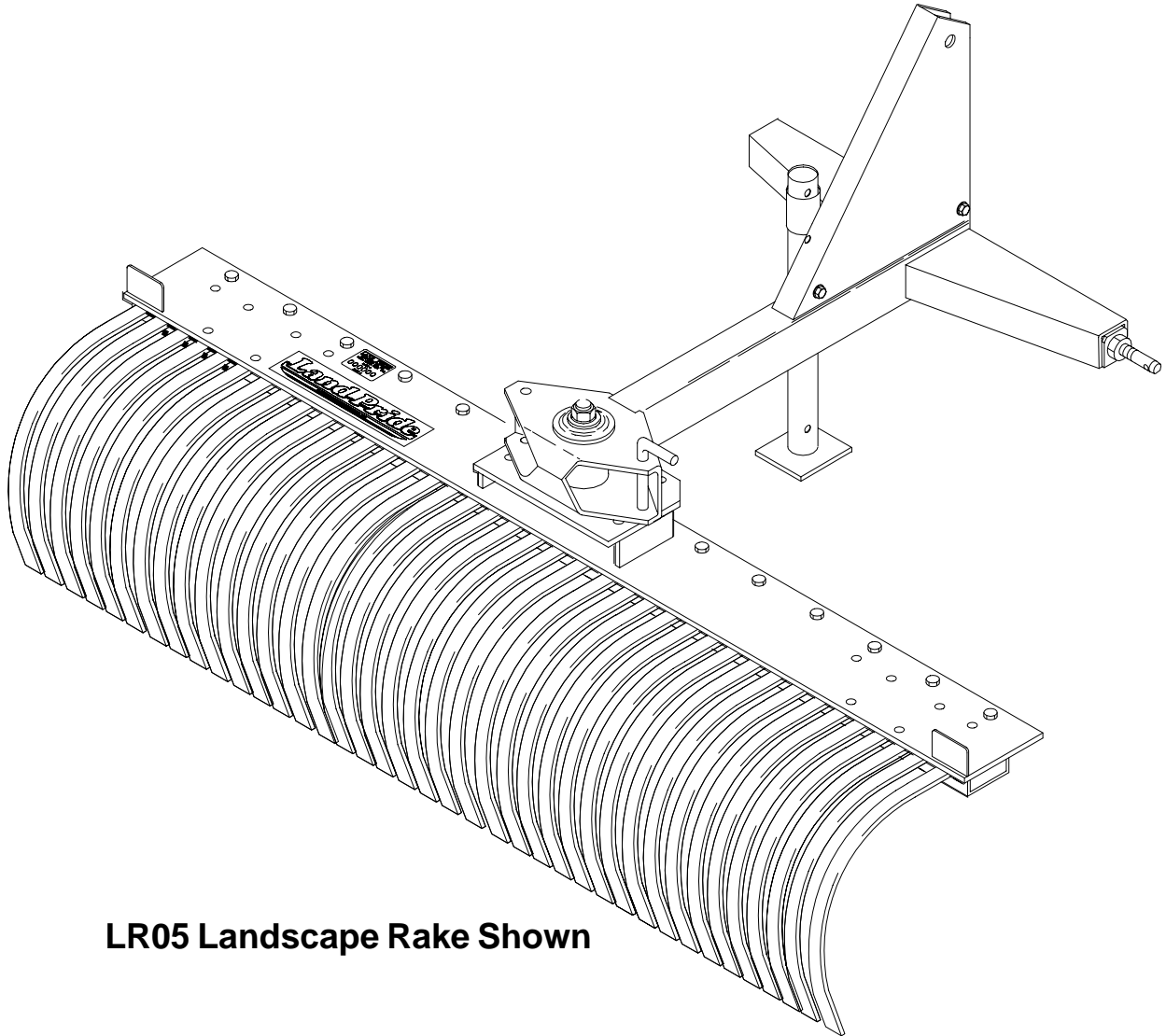

LR05 Landscape Rake Shown

10410

302-185M
Operator's Manual



Read the Operator's Manual entirely. When you see this symbol, the subsequent instructions and warnings are serious - follow without exception. Your life and the lives of others depend on it!

Cover photo may show optional equipment not supplied with standard unit.

© Copyright 2012 Printed 11/01/12



Important Safety Information	1	Section 4: Adjustments	13
Safety at All Times	1	Angling and reversing	13
Look For The Safety Alert Symbol	1	Pitch	13
Safety Labels	4	Rake Tilt	13
Introduction	5	Gauge Wheels (Optional)	13
Application	5	LR15 Flip Down Blade (Optional)	13
Using This Manual	5	Section 5: Maintenance & Lubrication	14
Owner Assistance	5	Maintenance	14
Serial Number	5	Lubrication	14
Section 1: Assembly & Set-up	6	LR15 Gauge Wheel	14
Tractor Requirements	6	Rake Teeth	14
Landscape Rakes	6	Section 6: Options	15
Support Stand Assembly	7	LR05 Dual Gauge Wheel	15
Tractor Hook-Up	7	LR15 Dual Gauge Wheel	15
Section 2: Optional Equipment Set-up	8	LR15 Flip Down Grader Blade	15
Dual Gauge Wheel (LR05 Series)	8	LR15 Grader Blade Mounting Arm	15
Gauge Wheel Assembly	8	LR15 Support Stand (Accessory)	15
Dual Gauge Wheel Installation (LR15)	9	Rear Blade Attachments (Accessory)	15
Gauge Wheel Assembly	9	Section 7: Specifications & Capacities	16
Grader Blade Installation (LR15)	9	Section 8: Features & Benefits	17
Grader Blade with Gauge Wheels	9	Section 9: Torque Values Chart	18
Grader Blade without Gauge Wheels	10	Section 10: Warranty	19
Grader Blade Side Plate Assembly	10		
LR15 Support Stand (Accessory)	10		
Section 3: Operating Instructions	11		
Operating Checklist	11		
Transporting	11		
Operating Instructions	11		
Operating Instructions	11		



© Copyright 2012 All rights Reserved

Land Pride provides this publication "as is" without warranty of any kind, either expressed or implied. While every precaution has been taken in the preparation of this manual, Land Pride assumes no responsibility for errors or omissions. Neither is any liability assumed for damages resulting from the use of the information contained herein. Land Pride reserves the right to revise and improve its products as it sees fit. This publication describes the state of this product at the time of its publication, and may not reflect the product in the future.

Land Pride is a registered trademark.

All other brands and product names are trademarks or registered trademarks of their respective holders.

Printed in the United States of America.

Important Safety Information

These are common practices that may or may not be applicable to the products described in this manual.

Safety at All Times

Thoroughly read and understand the instructions given in this manual before operation. Refer to the "Safety Label" section, read all instructions noted on them.

Do not allow anyone to operate this equipment who has not fully read and comprehended this manual and who has not been properly trained in the safe operation of the equipment.

- ▲ Operator should be familiar with all functions of the unit.
- ▲ Operate implement from the driver's seat only.
- ▲ Make sure all guards and shields are in place and secured before operating implement.
- ▲ Do not leave tractor or implement unattended with engine running.
- ▲ Dismounting from a moving tractor could cause serious injury or death.
- ▲ Do not allow anyone to stand between tractor and implement while backing up to implement.
- ▲ Keep hands, feet, and clothing away from power-driven parts.
- ▲ Wear snug fitting clothing to avoid entanglement with moving parts.
- ▲ Watch out for wires, trees, etc., when raising implement. Make sure all persons are clear of working area.
- ▲ Turning tractor too tight may cause implement to ride up on wheels. This could result in injury or equipment damage.
- ▲ Do not carry passengers on implement at any time.

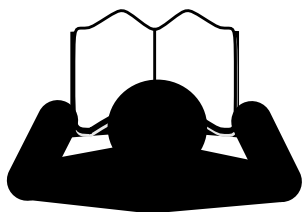

Look For The Safety Alert Symbol

The SAFETY ALERT SYMBOL indicates there is a potential hazard to personal safety involved and extra safety precaution must be taken. When you see this symbol, be alert and carefully read the message that follows it. In addition to design and configuration of equipment, hazard control, and accident prevention are dependent upon the awareness, concern, prudence, and proper training of personnel involved in the operation, transport, maintenance, and storage of equipment.

Be Aware of Signal Words

A Signal word designates a degree or level of hazard seriousness. The signal words are:

⚠ DANGER

Indicates an imminently hazardous situation which, if not avoided, will result in death or serious injury. This signal word is limited to the most extreme situations, typically for machine components that, for functional purposes, cannot be guarded.

⚠ WARNING

Indicates a potentially hazardous situation which, if not avoided, could result in death or serious injury, and includes hazards that are exposed when guards are removed. It may also be used to alert against unsafe practices.

⚠ CAUTION

Indicates a potentially hazardous situation which, if not avoided, may result in minor or moderate injury. It may also be used to alert against unsafe practices.

For Your Protection

- ▲ Thoroughly read and understand the "Safety Label" section, read all instructions noted on them.

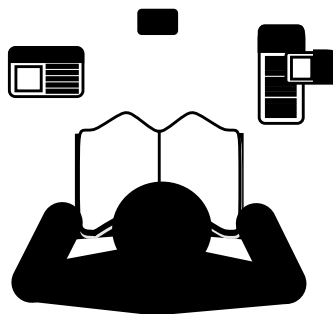

Shutdown and Storage

- ▲ Lower machine to ground, put tractor in park, turn off engine, and remove the key.
- ▲ Detach and store implements in an area where children normally do not play. Secure implement by using blocks and supports.

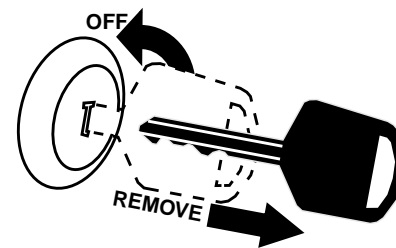

Parts Manual QR Locator

The QR (Quick Reference) code on the front cover and to the left will take you to the Parts Manual for this equipment. Download the appropriate App on your smart phone, open the App, point your phone on the QR code and take a picture.



Dealer QR Locator

The QR code on the left will link you to available dealers for Land Pride products. Refer to Parts Manual QR Locator on this page for detailed instructions.

These are common practices that may or may not be applicable to the products described in this manual.

Use Safety Lights and Devices

- ▲ Slow moving tractors, self-propelled equipment, and towed implements can create a hazard when driven on public roads. They are difficult to see, especially at night.
- ▲ Flashing warning lights and turn signals are recommended whenever driving on public roads.

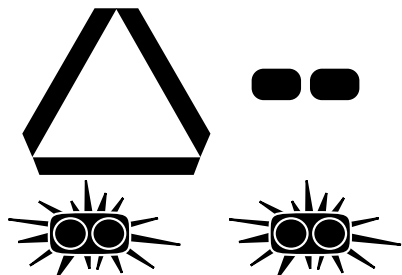

Transport Machinery Safely

- ▲ Comply with state and local laws.
- ▲ Maximum transport speed for implement is 20 mph. DO NOT EXCEED. Never travel at a speed which does not allow adequate control of steering and stopping. Some rough terrain require a slower speed.
- ▲ Sudden braking can cause a towed load to swerve and upset. Reduce speed if towed load is not equipped with brakes.

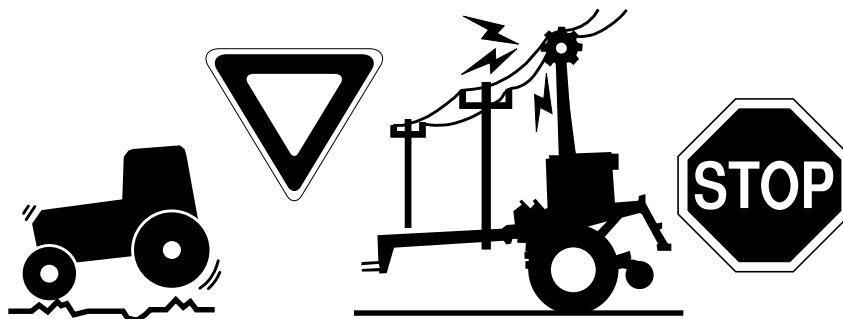

- ▲ Use the following maximum speed - tow load weight ratios as a guideline:
- ▲ **20 mph** when weight is less than or equal to the weight of tractor.
- ▲ **10 mph** when weight is double the weight of tractor.
- ▲ **IMPORTANT:** Do not tow a load that is more than double the weight of tractor.

Use A Safety Chain

- ▲ A safety chain will help control drawn machinery should it separate from the tractor drawbar.
- ▲ Use a chain with the strength rating equal to or greater than the gross weight of the towed machinery.
- ▲ Attach the chain to the tractor drawbar support or other specified anchor location. Allow only enough slack in the chain to permit turning.
- ▲ Do not use safety chain for towing.

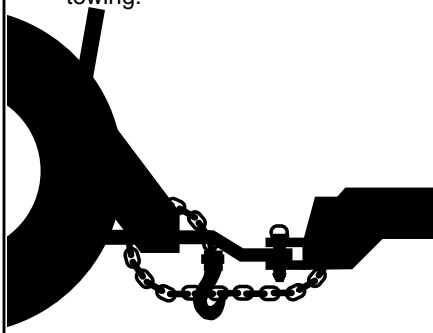

Practice Safe Maintenance

- ▲ Understand procedure before doing work. Use proper tools and equipment, refer to Operator's Manual for additional information.
- ▲ Work in a clean dry area.
- ▲ Lower the implement to the ground, put tractor in park, turn off engine, and remove key before performing maintenance.
- ▲ Allow implement to cool completely.
- ▲ Do not grease or oil implement while it is in operation.
- ▲ Inspect all parts. Make sure parts are in good condition & installed properly.
- ▲ Remove buildup of grease, oil, or debris.
- ▲ Remove all tools and unused parts from implement before operation.



Important Safety Information

These are common practices that may or may not be applicable to the products described in this manual.

Prepare for Emergencies

- ▲ Be prepared if a fire starts.
- ▲ Keep a first aid kit and fire extinguisher handy.
- ▲ Keep emergency numbers for doctor, ambulance, hospital, and fire department near phone.

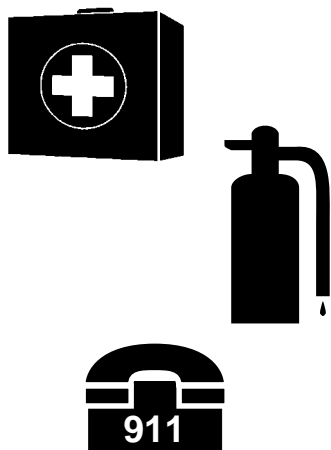

Wear Protective Equipment

- ▲ Wear protective clothing and equipment appropriate for the job. Avoid loose fitting clothing.
- ▲ Prolonged exposure to loud noise can cause hearing impairment or hearing loss. Wear suitable hearing protection such as earmuffs or earplugs.
- ▲ Operating equipment safely requires the full attention of the operator. Avoid wearing radio headphones while operating machinery.



Avoid High Pressure Fluids Hazard

- ▲ Escaping fluid under pressure can penetrate the skin causing serious injury.
- ▲ Avoid the hazard by relieving pressure before disconnecting hydraulic lines or performing work on the system.
- ▲ Make sure all hydraulic fluid connections are tight and all hydraulic hoses and lines are in good condition before applying pressure to the system.
- ▲ Use a piece of paper or cardboard, NOT BODY PARTS, to check for suspected leaks.
- ▲ Wear protective gloves and safety glasses or goggles when working with hydraulic systems.
- ▲ If an accident occurs, see a doctor immediately. Any fluid injected into the skin must be treated within a few hours or gangrene may result.



Keep Riders Off Machinery

- ▲ Riders obstruct the operator's view, they could be struck by foreign objects or thrown from the machine.
- ▲ Never allow children to operate equipment.

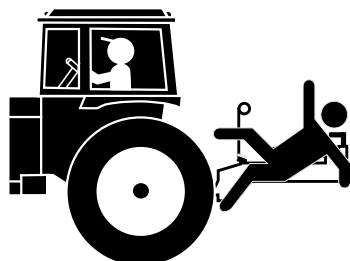

Tire Safety

- ▲ Tire changing can be dangerous and should be preformed by trained personnel using the correct tools and equipment.
- ▲ When inflating tires, use a clip-on chuck and extension hose long enough to allow you to stand to one side and NOT in front of or over the tire assembly. Use a safety cage if available.
- ▲ When removing and installing wheels, use wheel handling equipment adequate for the weight involved.



Handle Chemicals Properly

- ▲ Protective clothing should be worn.
- ▲ Handle all chemicals with care.
- ▲ Follow instructions on container label.
- ▲ Agricultural chemicals can be dangerous. Improper use can seriously injure persons, animals, plants, soil, and property.
- ▲ Inhaling smoke from any type of chemical fire is a serious health hazard.
- ▲ Store or dispose of unused chemicals as specified by the chemical manufacturer.



Important Safety Information

Safety Labels

Your Landscape Rake comes equipped with all safety labels in place. They were designed to help you safely operate your implement. Read and follow their directions.

1. Keep all safety labels clean and legible.
2. Refer to this section for proper label placement. Replace all damaged or missing labels. Order new labels from your nearest Land Pride dealer. To find your nearest dealer, visit our dealer locator at www.landpride.com.
3. Some new equipment installed during repair requires safety labels to be affixed to the replaced component as

specified by Land Pride. When ordering new components make sure the correct safety labels are included in the request.

4. Refer to this section for proper label placement. To install new labels:
 - a. Clean the area the label is to be placed.
 - b. Spray soapy water on the surface where the label is to be placed.
 - c. Peel backing from label. Press firmly onto the surface.
 - d. Squeeze out air bubbles with the edge of a credit card or with a similar type straight edge.

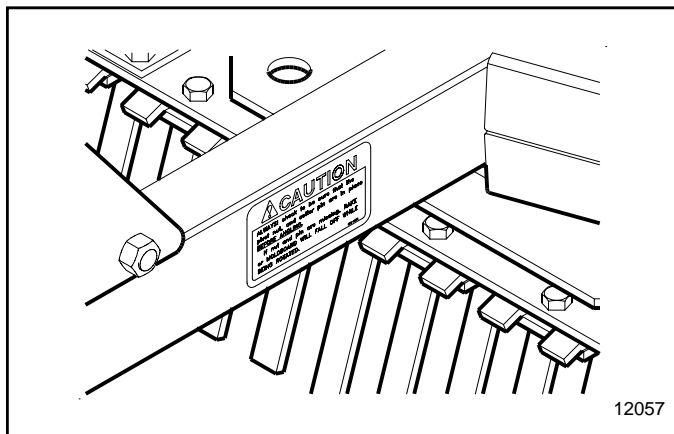

12057



818-202C

Caution: Retaining Nut

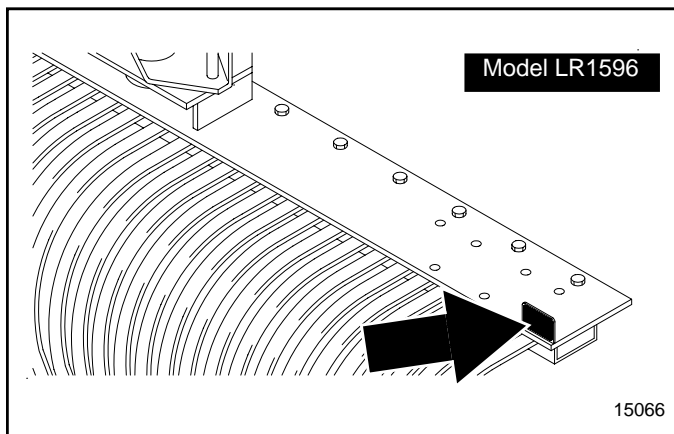

15066

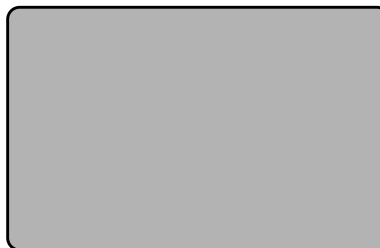

818-230C

Red Reflector (Back side of plate)

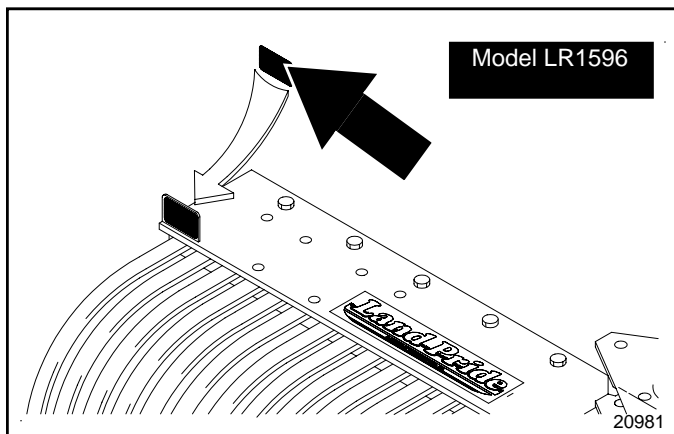

20981

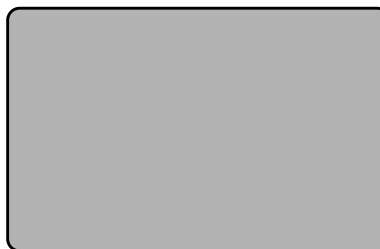

818-229C

Amber Reflector (Front side of plate) (Left side only)

Introduction

Land Pride welcomes you to the growing family of new product owners.

This Landscape Rake has been designed with care and built by skilled workers using quality materials. Proper assembly, maintenance, and safe operating practices will help you get years of satisfactory use from this machine.

Application

The LR05 and LR15 Series Landscape Rakes are designed and built by Land Pride to perform final soil surface preparation and reshaping soil and/or aggregate profile. LR05 Series are offered in 4 ft., 5 ft., and 6 ft. working widths with category 0-1 3-Point hitch for mounting to compact tractors in the 20hp range. LR15 Series rakes are offer in 5 ft., 6 ft., 7 ft., and 8 ft. working widths with category 1 three point hitch for mounting to tractors with 17 to 35hp capabilities. Both models offer angling and reversing capabilities to meet specific finishing needs. Optional gauge wheel packages are also available on both models to enable a more consistent finish over uneven or undulating terrain. Both series offers a flip-down grader to expedite material distribution and contouring tasks.

These Land Pride Landscape Rakes are perfectly suited for use by landscapers, contractors, and rental yards. They have applications at housing and road construction projects, golf courses, terracing sites, run-off control projects, and reforestation sights.

See “**Specifications & Capacities**” on page 16 and “**Features & Benefits**” on page 17 for additional information and performance enhancing options.

Using This Manual

- This Operator’s Manual is designed to help familiarize you with safety, assembly, operation, adjustments, troubleshooting, and maintenance. Read this manual and follow the recommendations to help ensure safe and efficient operation.
- The information contained within this manual was current at the time of printing. Some parts may change slightly to assure you of the best performance.
- To order a new Operator’s or Parts Manual contact your authorized dealer. Manuals can also be downloaded, free-of-charge from our website at www.landpride.com.

Terminology

“Right” or “Left” as used in this manual is determined by facing forward in the direction the machine will operate while in use unless otherwise stated.

Definitions

IMPORTANT: A special point of information related to the following topic. Land Pride’s intention is this information must be read & noted before continuing.

NOTE: A special point of information that the operator should be aware of before continuing.

Owner Assistance

The Online Warranty Registration or Warranty Registration card should be completed by the dealer at the time of purchase. This information is necessary to provide you with quality customer service.

The parts on your Landscape Rake have been specially designed by Land Pride and should only be replaced with genuine Land Pride parts. Contact a Land Pride dealer if customer service or repair parts are required. Your Land Pride dealer has trained personnel, repair parts, and equipment needed to service the implement.

Serial Number

Model No. _____ Serial No. _____

For quick reference and prompt service, record model number and serial number in the spaces provided above and again on warranty page 19. Always provide model and serial number when ordering parts and in all correspondences with your Land Pride dealer. Refer to Figure 1 for location of your serial number plate.

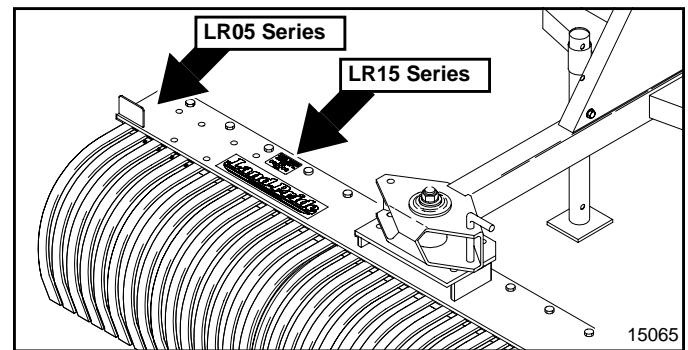

Serial Number Plate Location (LR15 Series shown)
Figure 1

Further Assistance

Your dealer wants you to be satisfied with your new Landscape Rake. If for any reason you do not understand any part of this manual or are not satisfied with the service received, the following actions are suggested:

1. Discuss the matter with your dealership service manager making sure that person is aware of any problems you may have and has had the opportunity to assist you.
2. If you are still not satisfied, seek out the owner or general manager of the dealership, explain the problem, and request assistance.
3. For further assistance write to:

Land Pride Service Department
1525 East North Street
P.O. Box 5060
Salina, Ks. 67402-5060

E-mail address
lp servicedept@landpride.com

Section 1: Assembly & Set-up

Tractor Requirements

Tractor horse power and hitch category should be within the range noted below. Tractors outside the horsepower range must not be used.

- Tractor Horse Power Rating

LR05 Series 15-20 HP
LR15 series 20-35 HP

- Hitch Category

LR05 Series Cat. 0 with Cat. 1 pins
LR15 Series Cat. 1

Landscape Rakes

Refer to Figure 1-1:

1. Insert rake assembly (#1) through opening in the main frame assembly (#2).
2. Place pivot cap (#3) over the threaded shaft protruding through the opening in the main frame assembly (#2).

3. Thread on slotted hex nut (#4) until vertical play is removed from pivot assembly.
4. Insert cotter pin (#5).
5. Line up holes in the rake assembly (#1) with holes in the mainframe assembly (#2) and insert lock pin (#6).
6. Position upper hitch mast (#7) on main frame (#2) and insert 1/2"-13 GR5 hex head cap screws (#8). Retain with lock washers (#9) and hex nuts (#10). Tighten to proper torque.
7. Some rake teeth may require repositioning due to crating. Loosen 3/8" lock nut (#11) and adjust/align these teeth to proper position. Retighten lock nut to the correct torque.

CAUTION

Always check to be sure slotted hex nut (#4) and cotter pin (#5) are in place before angling or reversing the rake. If they are missing, the rake will fall off while being rotated!

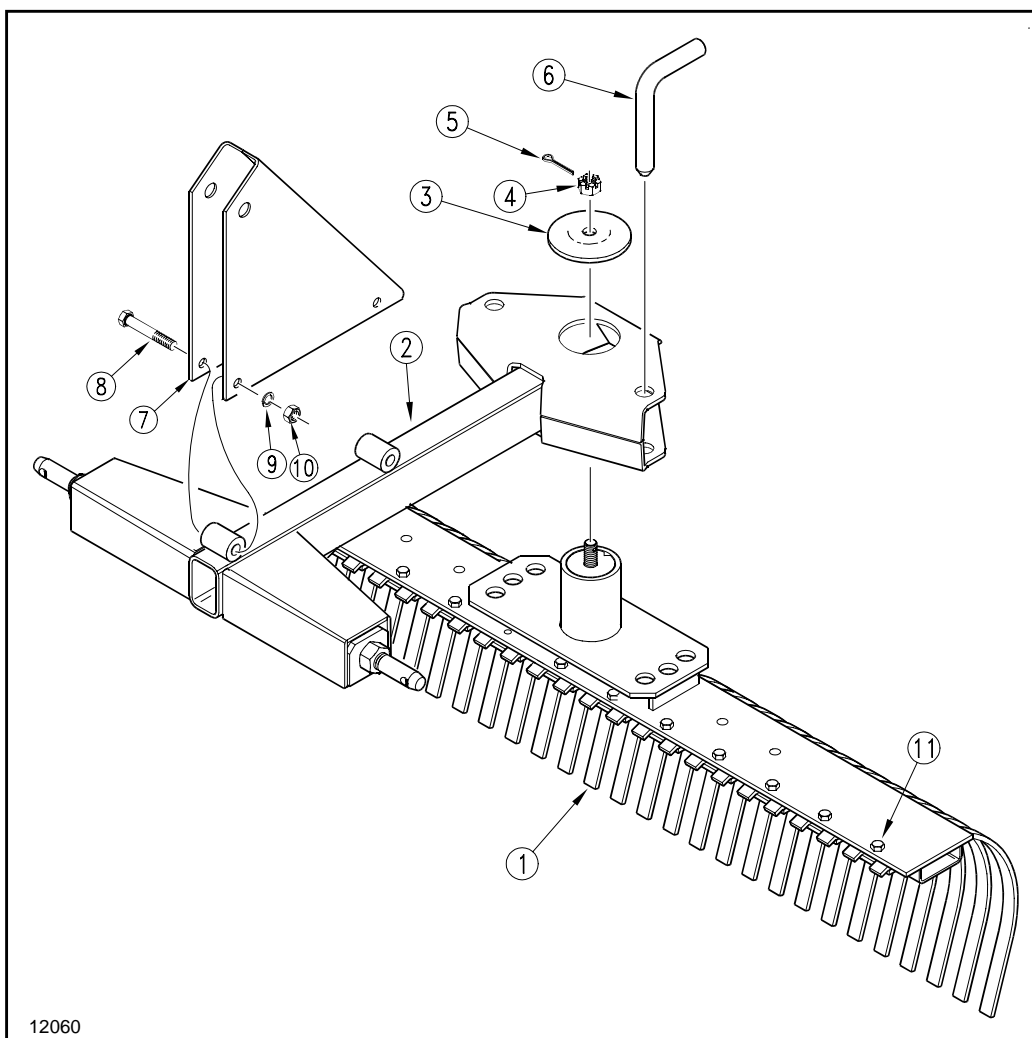

**LR05 and LR15 Assembly
Figure 1-1**

Section 1: Assembly & Set-up

Support Stand Assembly

Refer to Figure 1-2:

1. Insert wire retaining pin (#3) into support stand hole "B" and secure with wire retainer.
2. Insert support stand (#1) into tube (#2) until wire retaining pin (#3) is against bottom of tube.
3. Drive roll pin (#4) into hole "A" until pin extends beyond holes in support stand an equal amount on both sides.
4. To raise support stand up, remove wire retaining pin (#3) and raise support stand up until hole "C" is above tube (#2). Reinsert wire retaining pin (#3) into hole "C" and secure with wire retainer.

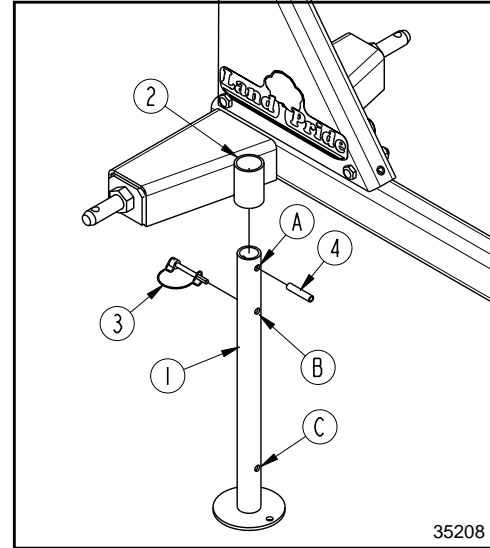

Support Stand Assembly
Figure 1-2

Tractor Hook-Up



DANGER

Tractor hook-up to equipment is dangerous and can result in serious injury or death. **Do not** allow anyone to stand between the Landscape Rake and tractor during hook-up operations. **Do not** operate the hydraulic 3-Point lift controls while someone is directly behind the tractor or near the rake.

Refer to Figure 1-3 & Figure 1-4:

1. Slowly back tractor up to the Landscape Rake while using the tractor's 3-Point hydraulic control to align the lower hitch link holes with the implement's lower hitch pins.
2. Engage tractor park brake, shut tractor engine off, and remove key before dismounting from tractor.
3. With tractor's lower hitch arms aligned and positioned, slide the lower hitch arm holes onto the hitch pins. Secure lower 3-Point arms on the hitch pins with linch pins.
4. Ensure that the lower hitch arms are blocked to prevent excessive side movement.
5. Raise support stand all the way up and pin in transport position.
6. Connect top center link to the upper pivot hitch mounting hole using customer supplied clevis pin and linch pin.
7. Return to the tractor and slowly operate controls up and down to ensure that the drawbar, tires, and other equipment on the tractor do not contact the rake frame and teeth. Move or remove the drawbar if it interferes.
8. Manually adjust one of the two lower lift arms up or down to level the rake from left to right.
9. Manually adjust length of the top center link to level the rake from front to rear.

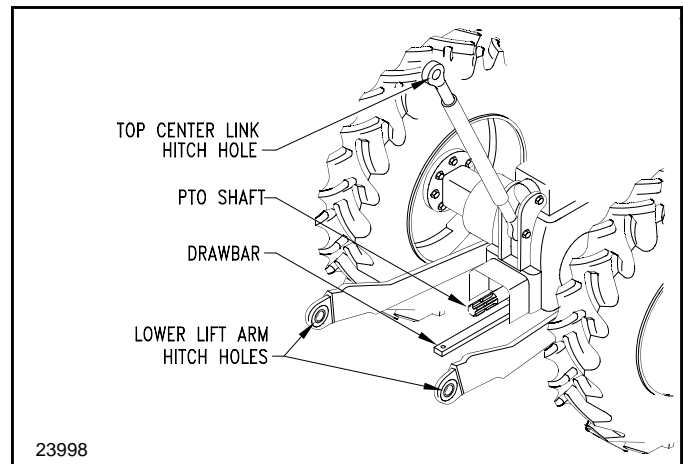

Tractor 3-Point Hitch
Figure 1-3

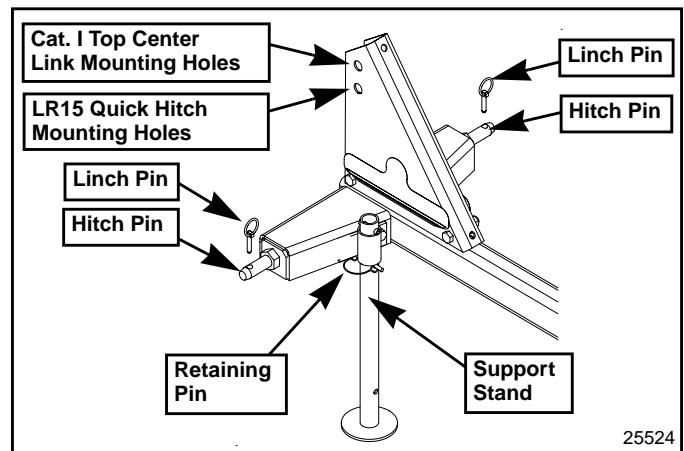

LR05 & LR15 Series 3-Point Hitch
Figure 1-4

Section 2: Optional Equipment Set-up

Dual Gauge Wheel (LR05 Series)

Refer to Figure 2-1:

Gauge Wheel Assembly

1. Attach gauge wheel arm (#1) to right-hand side of rake mount (#7) with four 3/8" x 2 1/4" GR5 hex head cap screws (#8), 3/8" lockwashers (#9), and 3/8" hex nuts (#10) as shown. Tighten to proper torque.
2. Insert two bushings (#5) onto gauge wheel arm (#1) as shown.
3. Insert yoke with tire assembly (#2) through 1/2" spacer (#3), 1" spacer (#4), bushings (#5), and two 1" Spacers (#4) as shown. Secure with linch pin (#6).
4. Repeat steps 1 - 3 to assemble gauge wheel on the left-hand side of the rake.

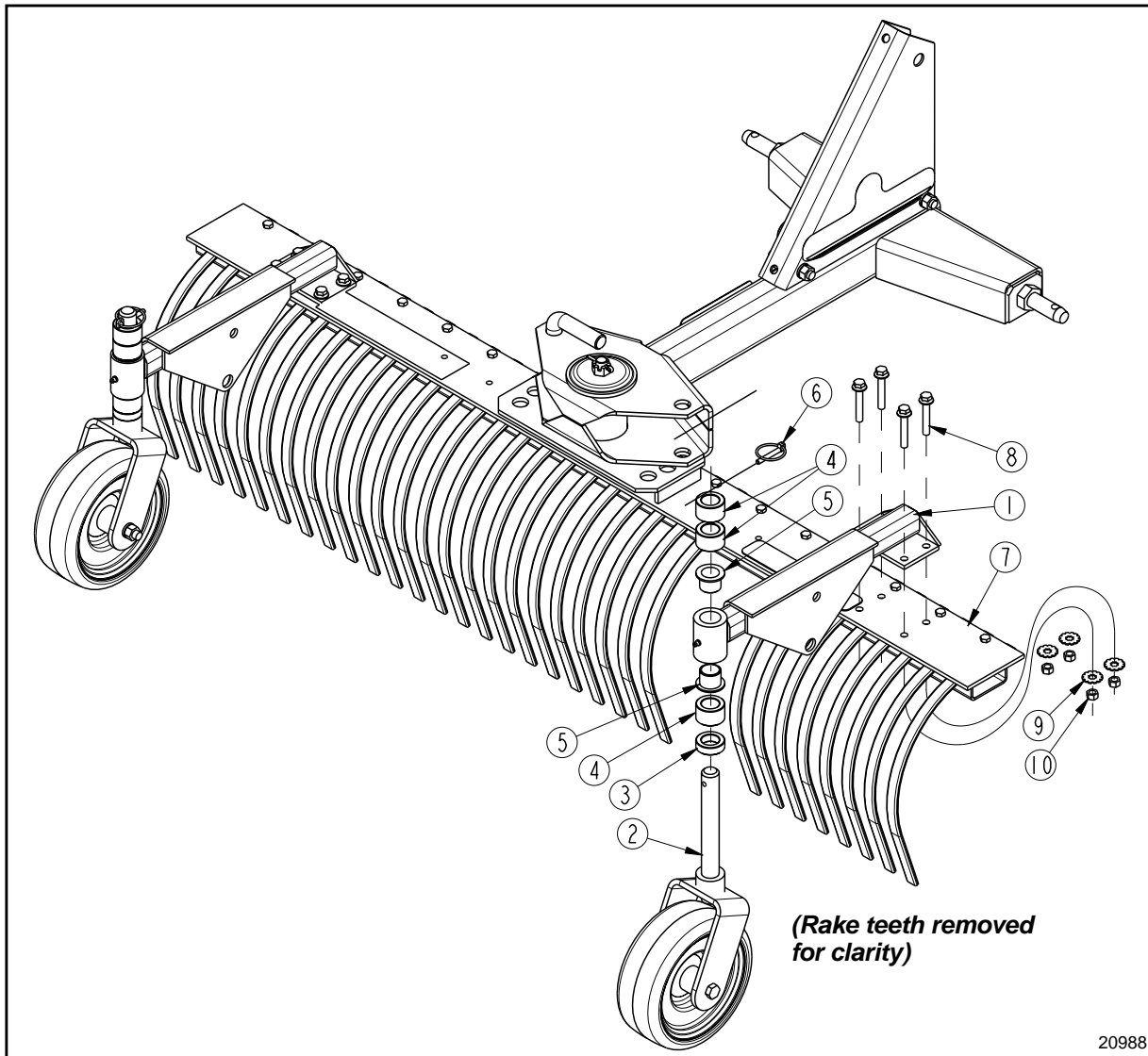

LR05 Dual Gauge Wheel Assembly
Figure 2-1

Dual Gauge Wheel Installation (LR15)

Refer to Figure 2-3:

Gauge Wheel Assembly

1. Attach gauge wheel arm (#1) to the right-hand side of rake mount (#7) with six 3/8" x 2 3/4" hex head bolts (#8), 3/8" lockwashers (#9), and 3/8" hex nuts (#10) as shown. Tighten to proper torque.
2. Insert two bushings (#5) into gauge wheel arm (#1) as shown.
3. Insert yoke with tire assembly (#2) through 1/2" spacer (#3), 1" spacer #4, spindles (#5), and three 1" Spacers (#4) as shown. Secure with wire retaining pin (#6).
4. Repeat steps 1 - 3 to assemble gauge wheel on the left-hand side of the rake.

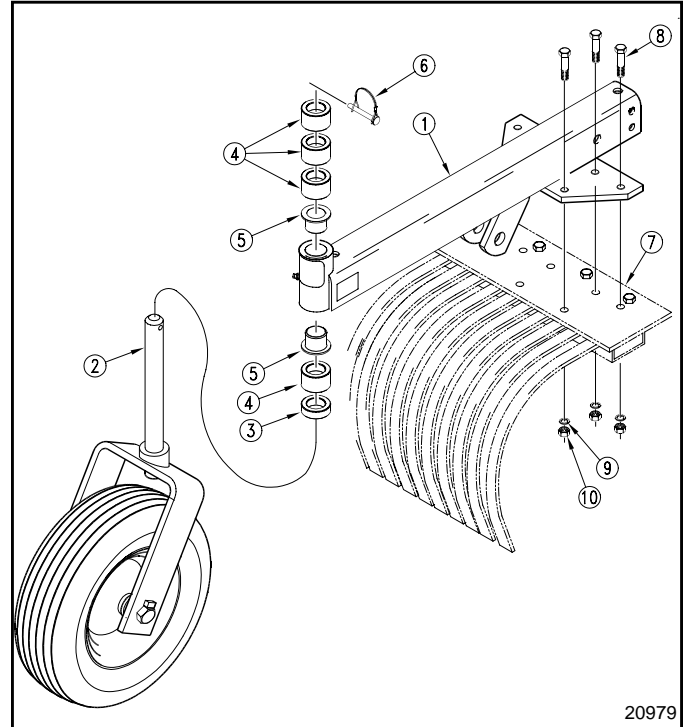

**Gauge Wheel Assembly
Right-Hand Assembly Shown
Figure 2-3**

Grader Blade Installation (LR15)

Grader Blade with Gauge Wheels

Refer to Figure 2-4:

NOTE: The grader blade can be supported from the dual gauge wheel support arms as shown in Figure 2-4. See Figure 2-5 on page 10 when mounting grader blade without gauge wheels.

1. Refer to "Dual Gauge Wheel Installation (LR15)" steps 1 - 4 on this page to assemble dual gauge wheels.
2. Attach blade lock handle (#3) to the right and left-hand Gauge Wheel Arms with 1/2" x 3" GR5 hex bolts (#2), lock washers (#14), and hex nuts (#15) as shown. Tighten to proper torque.
3. Insert pin (#1) through top hole of both gauge wheel arms. Secure with attached hair pin (#9) as shown.
4. Attach both the right end and left end of the grader blade (#11) to gauge wheel arms with 3/4" x 2 3/4" GR5 hex bolts (#12) and locknuts (#13) as shown. Do not torque locknut (#13).
5. Refer to "Grader Blade Side Plate Assembly" on page 10 for attaching side plates to both ends of the grader blade.

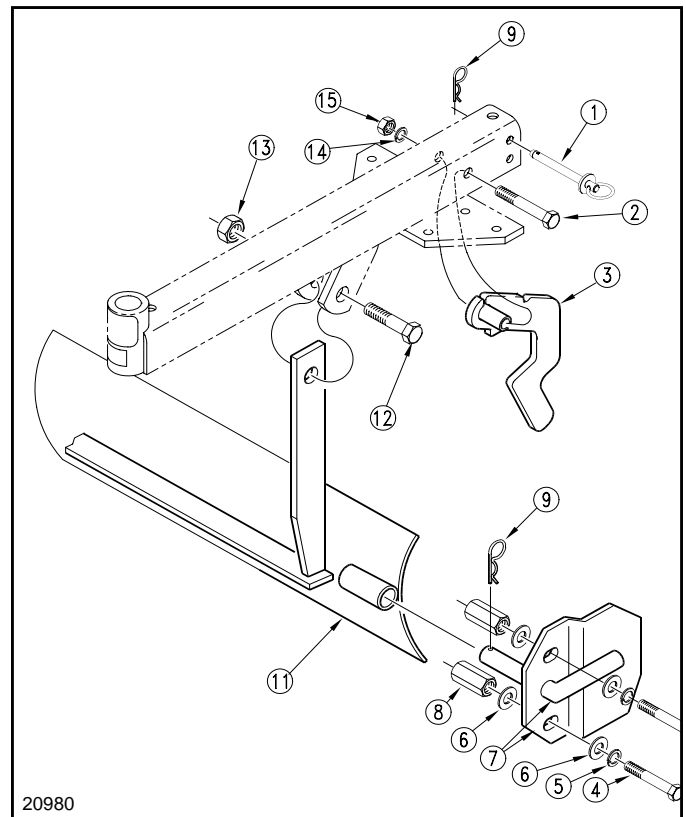

**Grader Blade Assembly with Gauge Wheel
Right-Hand Side Shown
Figure 2-4**

Section 2: Optional Equipment Set-up

Grader Blade without Gauge Wheels

Refer to Figure 2-5:

1. Attach blade support arms (#16) to the right and left side of rake mount (#20) with 3/8" x 2 3/4" GR5 hex bolts (#17), 3/8" lockwashers (#18), and 3/8" hex nuts (#19) (six bolts per support arm). Tighten to proper torque.
2. Attach blade lock handle (#3) to the right and left blade support arms with 1/2" x 3" GR5 hex bolts (#2), lock washers (#14), and hex nuts (#15) as shown. Tighten to proper torque.
3. Insert pin (#1) through the top hole in both blade support arms. Secure with hair pin (#9).
4. Attach the right and left end of grader blade (#11) to the blade support arms with 3/4" x 2 1/2" GR5 hex bolts (#12) and locknuts (#13). Do not torque locknuts (#13).

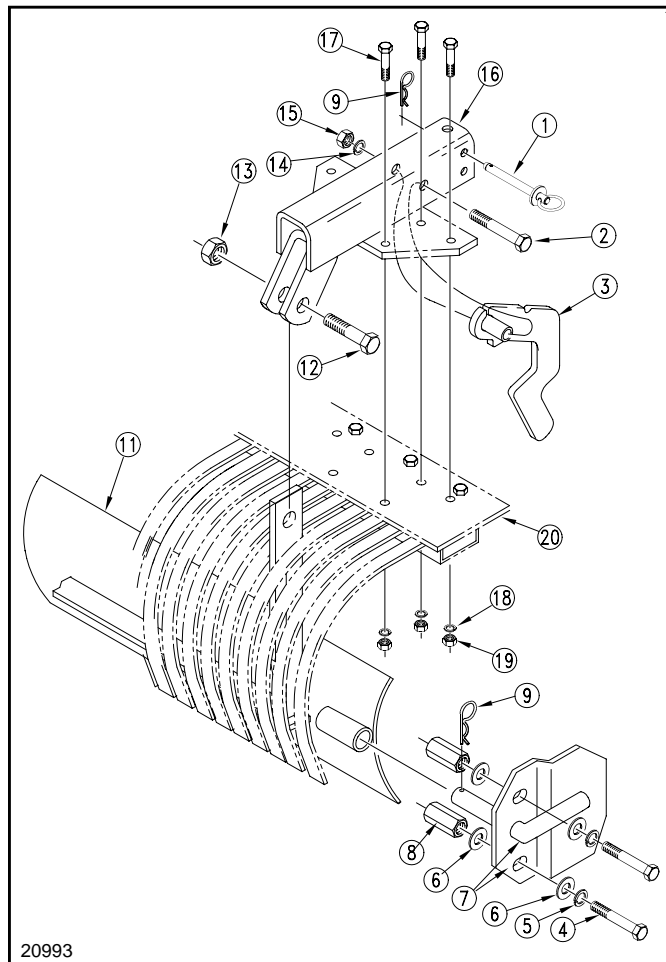

**Grader Blade Assembly without Gauge Wheel
Right-Hand Side Shown
Figure 2-5**

Grader Blade Side Plate Assembly

Refer to Figure 2-5:

1. Attach two hex coupler nuts (#8) with flat washer (#6) to side plates (#7) by inserting 7/16" x 1" GR5 hex bolts (#4) complete with lock washers (#5), and flat washers (#6) through the bottom and top holes as shown. Do not torque until step 3.
2. Insert pivot pin on side plates (#7) through the tubes located on the back side of grader blade (#11). Make certain coupler nuts (#8) are positioned behind the grader blade. Secure pivot pins with hair pins (#9)
3. Adjust hex coupler nuts3 (#8) against back side of grader blade and tighten bolts (#4) to proper torque.

LR15 Support Stand (Accessory)

Refer to Figure 2-6:

LR15 Series Landscape Rakes with serial number 475594 and higher are factory supplied with a support stand. You may purchase an accessory support stand from your nearest Land Pride dealer if the serial number on your rake is 475593 or below. For additional information, see "LR15 Support Stand (Accessory)" on page 15.

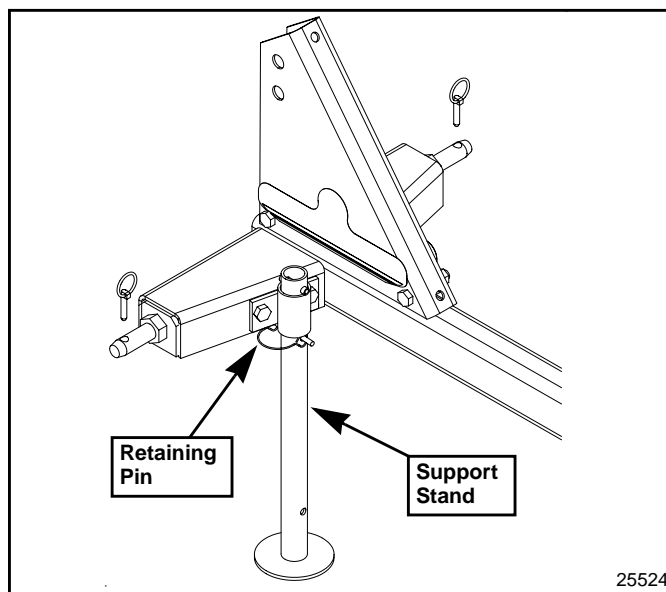

**LR15 Support Stand
(Accessory for units with s/n 475593-)
Figure 2-6**

Section 3: Operating Instructions

Operating Checklist

Hazard control and accident prevention are dependent upon the awareness, concern, prudence, and proper training involved in the operation, transport, storage, and maintenance of the blade. Therefore, it is absolutely essential that no one operates the Landscape Rake without first having read, fully understood, and become totally familiar with the Operator's Manual. Make sure the operator has paid particular attention to:

- **Important Safety Information**, pages 1 to 3
- **Section 1: Assembly & Set-up**, page 6
- **Section 2: Optional Equipment Set-up**, page 8
- **Section 3: Operating Instructions**, page 11
- **Section 4: Adjustments**, page 13
- **Section 5: Maintenance & Lubrication**, page 14

Operating Checklist

✓	Check	Referenc
	Check 3-Point hook-up procedure. Be sure all pins have been installed and are secured.	Page 7
	All rake adjustments have been made and pins have been installed and are secured.	Page 13
	The operator has read and understands how to operate the rake.	Page 11
	The Landscape Rake has been lubricated as required.	Page 14
	Check the rake initially and periodically for loose bolts & pins, See <i>Torque Values Chart</i> .	Page 18

Make the following inspections after attaching the Landscape Rake to the tractor:

1. Inspect tractor safety equipment to make sure it is in good working condition.
2. Carefully raise and lower the implement to ensure that the drawbar, tires, and other equipment on the tractor do not contact the frame and moldboard.
3. Carefully pivot rake fully clockwise such that the rake teeth closest to the tractor are in line with the tractor tire. Raise and lower implement to ensure tractor tires and tractor do not contact the rake.
4. Carefully pivot rake fully counterclockwise such that the rake teeth closest to the tractor is in line with the tractor tire. Raise and lower implement to ensure tractor tires and tractor do not contact the rake.

Transporting

 **CAUTION**

When traveling on public roads at night or during the day, use accessory lights and devices for adequate warning to operators of other vehicles. Comply with all federal, state, and local laws.

1. When traveling on roadways, transport in such a way that faster moving vehicles may pass you safely.
2. Leave enough clearance on both sides of the rake when traveling straight or making turns to keep the blade from contacting obstacles such as buildings, trees or fences.
3. Slow down when traveling over rough or hilly terrain.

Operating Instructions

 **WARNING**

Do not use the rake for pulling fence posts, stumps, etc., lifting objects, carry objects, or towing other equipment. Any of the above can result in rake damage, serious bodily injury, or death.

 **DANGER**

Never carry a person on the rake. A person can fall and be run over by the rake or tractor causing serious injury or death.

Operating Instructions

By now you should have thoroughly read your Operator's Manual and properly installed your Land Pride Landscape Rake to your tractor. Before you begin raking you should visually survey the work site to make sure it is safe and free of foreign obstacles. Also make certain that all irrigation heads, utility outlets, and other obstacles are properly marked.

Please stop and do the above checks and preparations if you have not yet done so before you begin to rake. This is a must for your safety and for the safety of others.

Now that you are properly briefed, your landscape rake is properly installed, and you have properly checked out your work site, it is time to begin raking. When transporting or travelling to and from work sites, make sure that the rake is in the fully raised position and not in contact with the ground. Select a safe speed and transport to your work site in such a manner that faster moving vehicles can pass you safely. A slow moving vehicle sign should be employed if you are using a public road or right-of way.

Section 3: Operating Instructions

Once you have safely arrived at your work site, lower your rake with the 3-Point hitch control lever so that the rake is just barely off of the ground. Lock the tractor brake to prevent rolling, shut off the tractor, and remove the ignition key before dismounting. Make the necessary angle, pitch, and gauge wheel adjustments to the rake to achieve desired results.

- Changing the rake angle to left or right will distribute extraneous and oversized material in furrows to the left or right.
- Changing the pitch angle of the rake by adjusting the top link in or out to tilt the bottom in toward the tractor will result in more aggressive action and vice-versa.
- Setting the proper height on the adjustable gauge wheels will enable a consistent raking that is less affected by uneven ground conditions encountered by the tractor wheels.

After you have made your initial adjustments and settings, get back on the tractor and make a gear and engine rpm selection that will enable a ground speed safe and suitable for your ground and operating conditions. Lower the rake into operating position and begin working. Achieving the desired affect may require additional adjustments.

With a little practice you should begin to consistently achieve the desired results. Always keep safety uppermost in your mind and remember that before dismounting the tractor you must always set the park brake, lower your 3-Point attachment to the ground, turn off the tractor and remove the ignition key. If you must park on a hillside you should always chock the tractor wheels for an extra measure of safety.

See “**Specifications & Capacities**” on page 16 and “**Features and Benefits**” on page 17 for additional information on performance enhancing options.

Section 4: Adjustments

Angling and reversing

Refer to Figure 4-1:

Six holes are provided for angling the rake in either the forward or reverse position. The rake can be angled horizontally 15 degrees to each side of center.

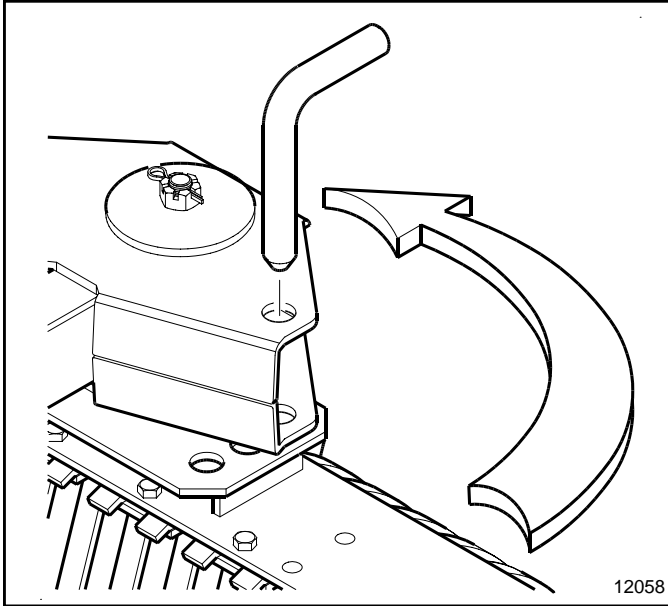

Rake Angling
Figure 4-1

Pitch

The pitch of the rake can be adjusted by lengthening or shortening the tractor's 3-Point top center link arm. See tractor manual to adjust the 3-Point top center arm.

Rake Tilt

The rake may be tilted so one end is lower than the other by adjusting the tractor's lower 3-Point arms. See tractor manual to adjust the lower 3-Point arms.

Gauge Wheels (Optional)

Refer to Figure 2-1 on page 8 & Figure 2-3 on page 9:

1. Remove pin (#6) from yoke shaft (#2).
2. Remove gauge wheel with yoke shaft (#2) from support arm (#1).
3. Place desired number of spacers (#3 & #4) on the yoke shaft.
4. Replace gauge wheel assembly (#2) into the support arm (#1).
5. Place remaining spacers (#3 & #4) on the yoke shaft above the support arm (#1) and reattach pin (#6).

LR15 Flip Down Blade (Optional)

Refer to Figure 4-2:

The LR15 grader blade may be stored in the up position when not in use and lowered when needed.

1. Carefully pivot blade upward until it contacts the blade lock handles (#1). A lock pin (#2) should be placed in the lower hole to ensure that the grader blade remains securely in the raised position.
2. Lower blade by removing the lock pin from the lower hole and replace in upper hole.
3. Pull blade lock handle (#1) to allow grader blade to flip down.

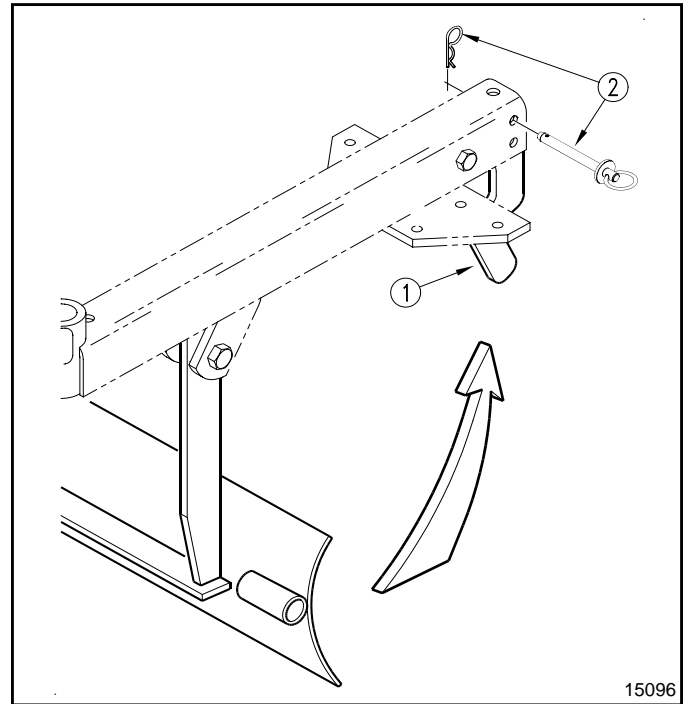

Grader Blade Lock Up Position
Figure 4-2

Section 5: Maintenance & Lubrication

Maintenance

Proper servicing and adjustment is the key to the long life of any implement. With careful and systematic inspection, you can avoid costly maintenance, time, and repair.

After using your Landscape Rake for several hours, check all bolts to be sure they are tight.

Replace any worn, damaged, or illegible safety labels by obtaining new labels from your Land Pride Dealer.

Lubrication

Lubrication Legend	Multi-purpose spray lube	Multi-purpose grease lube	Multi-purpose oil lube	50 Hrs	Intervals in hours at which lubrication is required

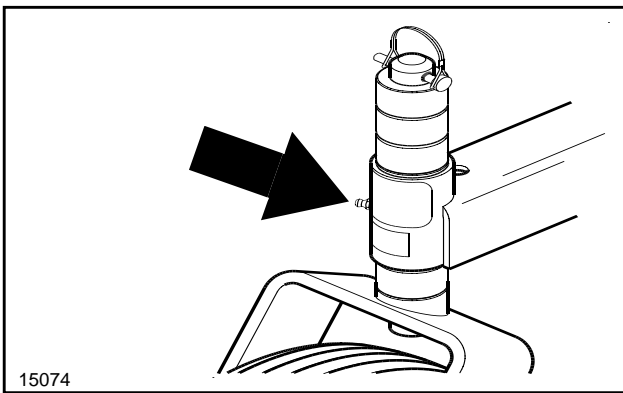

	25 Hours
--	----------

LR15 Gauge Wheel

Grease the gauge wheel zerk every 25 hours.

Type of Lubrication: Multi-Purpose

Quantity = Until grease begins to emerge.

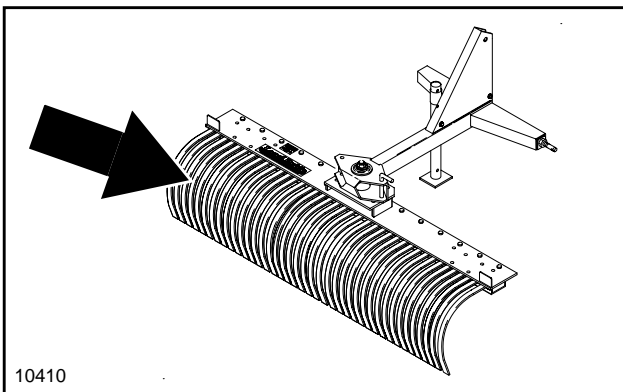

	Seasonally
--	------------

Rake Teeth

Grease before extended non-use or seasonally.

Type of Lubrication: Multi-Purpose

Quantity = Generously

Section 6: Options

LR05 Dual Gauge Wheel

Note: Arm of Dual Gauge Wheel provides a mount to support a grader blade.

Kit Bundle

302-258A DUAL GAUGE WHEELS-Solid 2 3/4" x 8 1/4"

LR15 Dual Gauge Wheel

Note: Arm of Dual Gauge Wheel provides a mount to support a grader blade.

Kit Bundles

302-176A DUAL GAUGE WHEELS-Narrow
 302-174A DUAL GAUGE WHEELS-Wide

LR15 Flip Down Grader Blade

Note: LR15 grader blade assembly is complete with side plates only. Grader Blade Mounting Arms must be purchased separately if Dual Gauge Wheels are not mounted on the Landscape rake.

Kit Bundles

302-152A 5' GRADER BLADE
 302-105A 6' GRADER BLADE
 302-106A 7' GRADER BLADE
 302-107A 8' GRADER BLADE

LR15 Grader Blade Mounting Arm

Note: Two Grader Blade Mounting Arms are required to support a Flip Down Grader Blade.

302-260A GRADER BLADE MOUNT LESS DUAL GAUGE WHEEL

LR15 Support Stand (Accessory)

LR15 Series Landscape Rakes with serial number 475594 and higher are factory supplied with a support stand. You may purchase an accessory support stand from your nearest Land Pride dealer if the serial number on your rake is 475593 or below. Assembly instructions are included with the stand.

Kit Bundle

300-196A LR15 SUPPORT STAND

Rear Blade Attachments (Accessory)

The rake assembly can be removed from the main frame and a RB15 Series rear blade assembly can be attached to the frame to give the Land Pride Rake versatility. The rear blade is not available in the 96" width. Be careful not to overstress the rear blade while back-filling as load forces on the blade and frame increase while backing-up.

Kit Bundles

301-115A 60" REAR BLADE ASSEMBLY (S/N 33160 & Above)
 301-116A 72" REAR BLADE ASSEMBLY (S/N 33160 & Above)
 301-117A 84" REAR BLADE ASSEMBLY (S/N 33160 & Above)

LR05 & LR15 Series Landscape Rakes

	LR0548	LR0560	LR1560	LR1572	LR1584	LR1596
Rake Width	48"	60"	60"	72"	84"	96"
Approximate Weight 6(lbs.)	98	113	241	270	291	316
Horsepower Rating	15-20		20-35			
Rake Height	12"		16 1/2"			
Hitch Type	Cat. 0 With Cat. 1 pins		Cat. 1 Fits Land Pride Quick Hitch			
Parking Stand	Standard					
Individual Replaceable Teeth	Standard					
Number of Teeth	26	34	30	36	42	48
Teeth Size	1/4" x 3/4" wide		5/16" x 1" wide			
Teeth Spacing	1 3/4" Centers		2" Centers			
Teeth Material	High Carbon Spring Steel					
Angle and Position	5 Forward / 5 Reverse 30 degrees Right or left		5 Forward 30 Degrees Right or Left 7 Reverse 45 Degrees Right or Left			
Gauge Wheel Option*	Dual Solid Wheels 8 1/4" x 2 3/4"		Dual Narrow Width Wheels 13" x 4" x 6" Dual Wide Width Wheels 13" x 6 1/2" x 6"			
Flip Down Grader Blade Option	Not Available		Flip Down Self Supporting Grader Blade with Blade-up Locking Handles and locking pins			
Rear Blade Attachment Accessory	Not Available		Available	Available	Available	Not Available

* Dual gauge wheels are capable of supporting the optional grader blades.

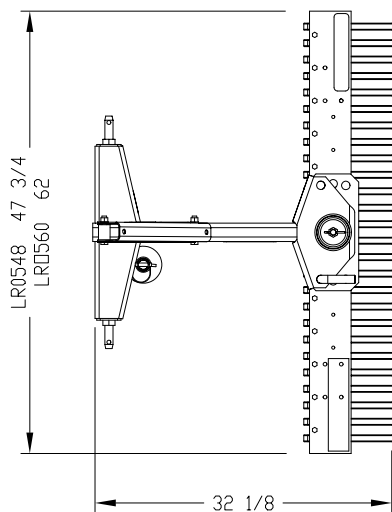

26767

LR05 Series Landscape Rakes

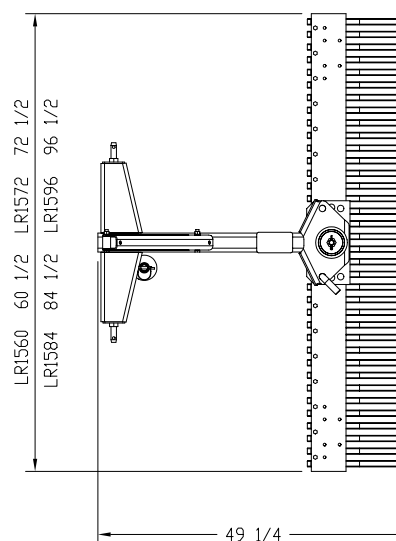

27554

LR15 Series Landscape Rakes



LR05 Series

Features	Benefits
48" & 60" working widths	Allows adaptability to many tractor sizes.
15-20 Tractor HP Range	Fits tractors with a Cat. 0 & Cat. I 3-Point hitch
Cat. 0 with Cat. 1 pins	Fits smaller tractors with Cat. 0 hitch.
Retractable Parking Stand	Keeps the frame off the ground and makes hook-up easier.
Rake teeth support channel	Design with channel support. This design supports the rake teeth better than competitor models. Prevents teeth entanglement and keeps attachment hardware from working loose.
1/4' x 3/4" High carbon spring steel teeth	Sized to eliminates premature bending and tooth breakage. Constructed of materials that have "memory" to spring back to shape.
Individual Replaceable teeth	Makes replacing a damaged tooth quick and easy without removing all of the teeth.
5 Forward angles	Vary how much material to move.
Optional Dual Gauge Wheels	Ease of depth control and provides attachments for a grader blade.
Warranty	One year parts & labor.

LR15 Series

Features	Benefits
60", 72", 84", 96" working widths	Meets a wide range of customer needs.
20-35 Tractor HP Range	Fits many tractors with a Cat. I 3-Point hitch.
Quick-Hitch adaptable	Fits Land Pride Quick-Hitch for a quick and easy one person hook-up.
Retractable Parking Stand	Keeps the frame off the ground and makes hook-up easier.
3 1/2" Pivot tube	Heavy frame tube. Heaviest in its class.
16 1/2" Rake height	Can move a great deal of material.
Rake teeth support channel	Design with channel support. This design supports the rake teeth better than competitor models. Prevents teeth entanglement and keeps attachment hardware from working loose.
5/16' x 1" High carbon spring steel teeth	Sized to eliminates premature bending and tooth breakage. Constructed of materials that have "memory" to spring back to shape.
Individual Replaceable teeth	Makes replacing a damaged tooth quick and easy without removing all of the teeth.
Angle 7 forward positions and 5 reverse positions	Versatility in operation. Vary how much material to move.
Dual gauge wheels	Gives operator better depth control. Wide & Narrow wheels available.
Flip-down grader blade with end plates (optional)	Enables the rake to perform light blading duties for moving and leveling dirt as well as other materials. Grader blade can be flipped up when not in use.
Rear Blade Attachment Accessory	The rake assembly can be removed from the main frame and a RB15 Series rear blade assembly can be attached to the frame to give the Land Pride Rake versatility.
Flip-down grader blade with end plates (optional)	Enables the rake to perform light blading duties for moving and leveling dirt as well as other materials. Grader blade can be flipped up when not in use.
Rear Blade Attachment Accessory	The rake assembly can be removed from the main frame and a RB15 Series rear blade assembly can be attached to the frame to give the Land Pride Rake versatility.

Section 9: Torque Values Chart

Torque Values Chart for Common Bolt Sizes													
Bolt Size (Inches) in-tpi ¹	Bolt Head Identification						Bolt Size (Metric) mm x pitch	Bolt Head Identification					
	Grade 2		Grade 5		Grade 8			Class 5.8		Class 8.8		Class 10.9	
	N · m	ft-lb ³	N · m	ft-lb	N · m	ft-lb		N · m	ft-lb	N · m	ft-lb	N · m	ft-lb
1/4" - 20	7.4	5.6	11	8	16	12	M 5 X 0.8	4	3	6	5	9	7
1/4" - 28	8.5	6	13	10	18	14	M 6 X 1	7	5	11	8	15	11
5/16" - 18	15	11	24	17	33	25	M 8 X 1.25	17	12	26	19	36	27
5/16" - 24	17	13	26	19	37	27	M 8 X 1	18	13	28	21	39	29
3/8" - 16	27	20	42	31	59	44	M10 X 1.5	33	24	52	39	72	53
3/8" - 24	31	22	47	35	67	49	M10 X 0.75	39	29	61	45	85	62
7/16" - 14	43	32	67	49	95	70	M12 X 1.75	58	42	91	67	125	93
7/16" - 20	49	36	75	55	105	78	M12 X 1.5	60	44	95	70	130	97
1/2" - 13	66	49	105	76	145	105	M12 X 1	90	66	105	77	145	105
1/2" - 20	75	55	115	85	165	120	M14 X 2	92	68	145	105	200	150
9/16" - 12	95	70	150	110	210	155	M14 X 1.5	99	73	155	115	215	160
9/16" - 18	105	79	165	120	235	170	M16 X 2	145	105	225	165	315	230
5/8" - 11	130	97	205	150	285	210	M16 X 1.5	155	115	240	180	335	245
5/8" - 18	150	110	230	170	325	240	M18 X 2.5	195	145	310	230	405	300
3/4" - 10	235	170	360	265	510	375	M18 X 1.5	220	165	350	260	485	355
3/4" - 16	260	190	405	295	570	420	M20 X 2.5	280	205	440	325	610	450
7/8" - 9	225	165	585	430	820	605	M20 X 1.5	310	230	650	480	900	665
7/8" - 14	250	185	640	475	905	670	M24 X 3	480	355	760	560	1050	780
1" - 8	340	250	875	645	1230	910	M24 X 2	525	390	830	610	1150	845
1" - 12	370	275	955	705	1350	995	M30 X 3.5	960	705	1510	1120	2100	1550
1-1/8" - 7	480	355	1080	795	1750	1290	M30 X 2	1060	785	1680	1240	2320	1710
1-1/8" - 12	540	395	1210	890	1960	1440	M36 X 3.5	1730	1270	2650	1950	3660	2700
1-1/4" - 7	680	500	1520	1120	2460	1820	M36 X 2	1880	1380	2960	2190	4100	3220
1-1/4" - 12	750	555	1680	1240	2730	2010	¹ in-tpi = nominal thread diameter in inches-threads per inch ² N · m = newton-meters ³ ft-lb= foot pounds ⁴ mm x pitch = nominal thread diameter in millimeters x thread pitch						
1-3/8" - 6	890	655	1990	1470	3230	2380							
1-3/8" - 12	1010	745	2270	1670	3680	2710							
1-1/2" - 6	1180	870	2640	1950	4290	3160							
1-1/2" - 12	1330	980	2970	2190	4820	3560							

Torque tolerance + 0%, -15% of torquing values. Unless otherwise specified use torque values listed above.

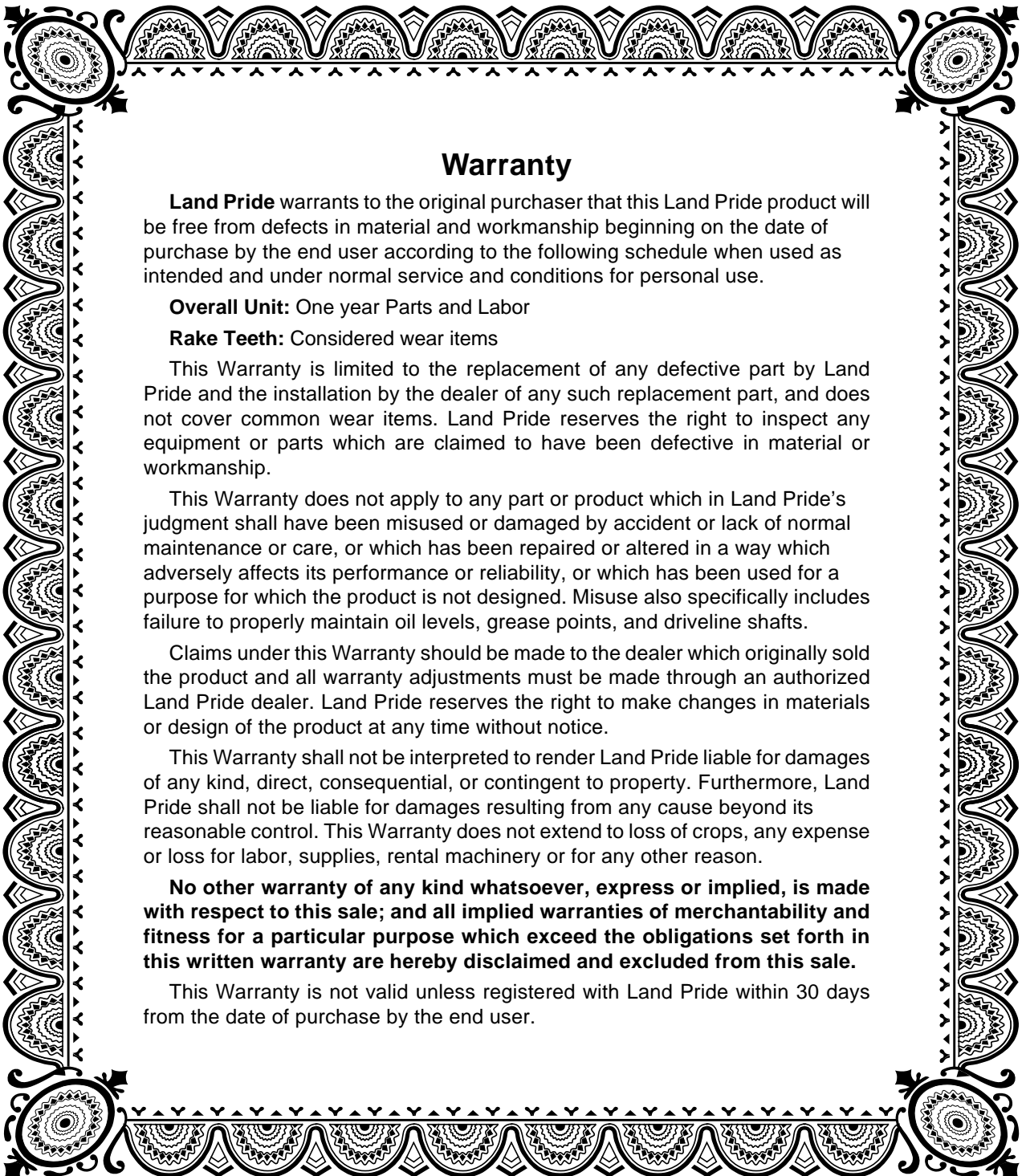

Warranty

Land Pride warrants to the original purchaser that this Land Pride product will be free from defects in material and workmanship beginning on the date of purchase by the end user according to the following schedule when used as intended and under normal service and conditions for personal use.

Overall Unit: One year Parts and Labor

Rake Teeth: Considered wear items

This Warranty is limited to the replacement of any defective part by Land Pride and the installation by the dealer of any such replacement part, and does not cover common wear items. Land Pride reserves the right to inspect any equipment or parts which are claimed to have been defective in material or workmanship.

This Warranty does not apply to any part or product which in Land Pride's judgment shall have been misused or damaged by accident or lack of normal maintenance or care, or which has been repaired or altered in a way which adversely affects its performance or reliability, or which has been used for a purpose for which the product is not designed. Misuse also specifically includes failure to properly maintain oil levels, grease points, and driveline shafts.

Claims under this Warranty should be made to the dealer which originally sold the product and all warranty adjustments must be made through an authorized Land Pride dealer. Land Pride reserves the right to make changes in materials or design of the product at any time without notice.

This Warranty shall not be interpreted to render Land Pride liable for damages of any kind, direct, consequential, or contingent to property. Furthermore, Land Pride shall not be liable for damages resulting from any cause beyond its reasonable control. This Warranty does not extend to loss of crops, any expense or loss for labor, supplies, rental machinery or for any other reason.

No other warranty of any kind whatsoever, express or implied, is made with respect to this sale; and all implied warranties of merchantability and fitness for a particular purpose which exceed the obligations set forth in this written warranty are hereby disclaimed and excluded from this sale.

This Warranty is not valid unless registered with Land Pride within 30 days from the date of purchase by the end user.

Model Number _____

Serial Number _____



Corporate Office: P.O. Box 5060
Salina, Kansas 67402-5060 USA
www.landpride.com
